

ELECTRICAL SITE NOTES

- ALL CONDUIT FOR ELECTRICAL SERVICE SHALL BE INSTALLED PER UTILITY STANDARDS AND SHALL HAVE MINIMUM 42" COVER. CONTRACTOR SHALL BE RESPONSIBLE FOR FILING WITH UTILITY AND INSTALLING PER UTILITY INSTRUCTIONS.
- CONTRACTOR SHALL INSTALL ALL TELEPHONE CONDUIT IN COORDINATION WITH TELEPHONE COMPANY STANDARDS. CONTACT PHONE COMPANY BEFORE ANY WORK BEGINS.
- CONTRACTOR SHALL INSTALL ALL CABLES AND CONDUIT PER CABLE COMPANY STANDARDS. COORDINATE AS REQUIRED.
- CONTRACTOR TO COORDINATE ALL METERING REQUIREMENTS WITH UTILITY COMPANY. FAILURE TO COORDINATE WILL NOT JUSTIFY ADDITIONAL COMPENSATION TO THE CONTRACTOR.
- ALL UTILITIES, INCLUDING ELECTRICAL DISTRIBUTION AND COMMUNICATION SHALL BE INSTALLED BELOW GRADE AS REQUIRED.
- EXTERIOR LIGHTS SHALL BE CONTROLLED BY A PHOTOCELL AND TIME CLOCK CONTROL. MOUNT OUTDOOR PHOTOCELL HORIZONTALLY ON ROOF OR EQUAL, FACING NORTHERN SKY. HOODED PORTION ON TOP, POINTED AWAY FROM ANY NIGHT TIME LIGHT SOURCES. TIME SWITCH SHALL BE CAPABLE OF RETAINING PROGRAMMING AND THE TIME SETTING DURING LOSS OF POWER FOR A PERIOD OF AT LEAST 10 HOURS. ALL EXTERIOR LIGHTS SHALL BE LISTED DARK SKY COMPLIANT.
- EXTERIOR LIGHTING SHALL BE INSTALLED PER THE CITY OF DALLAS ELECTRICAL ORDINANCE AND IN CONJUNCTION WITH THE 2023 NEC.

Label	Calc Type	Units	Avg	Max	Min	Avg/Min	Max/Min
EXTERIOR	Illuminance	Fc	2.66	10.3	0.1	25.00	102.00
PARKING GARAGE	Illuminance	Fc	4.87	8.6	2.7	1.80	3.19

Symbol	Qty	Label	Description	Lum. Lumens	Lum. Watts	(MANUFACT)
□	24	S	DISP LED 10C 1000 30K T	3604	37	Litonia Lighting
○	29	X	WLSQO-C-L22-840-BZ	1990	20	H.E. Williams
○	9	Y	WLSQO-C-L22-840-BZ	1990	20	H.E. Williams

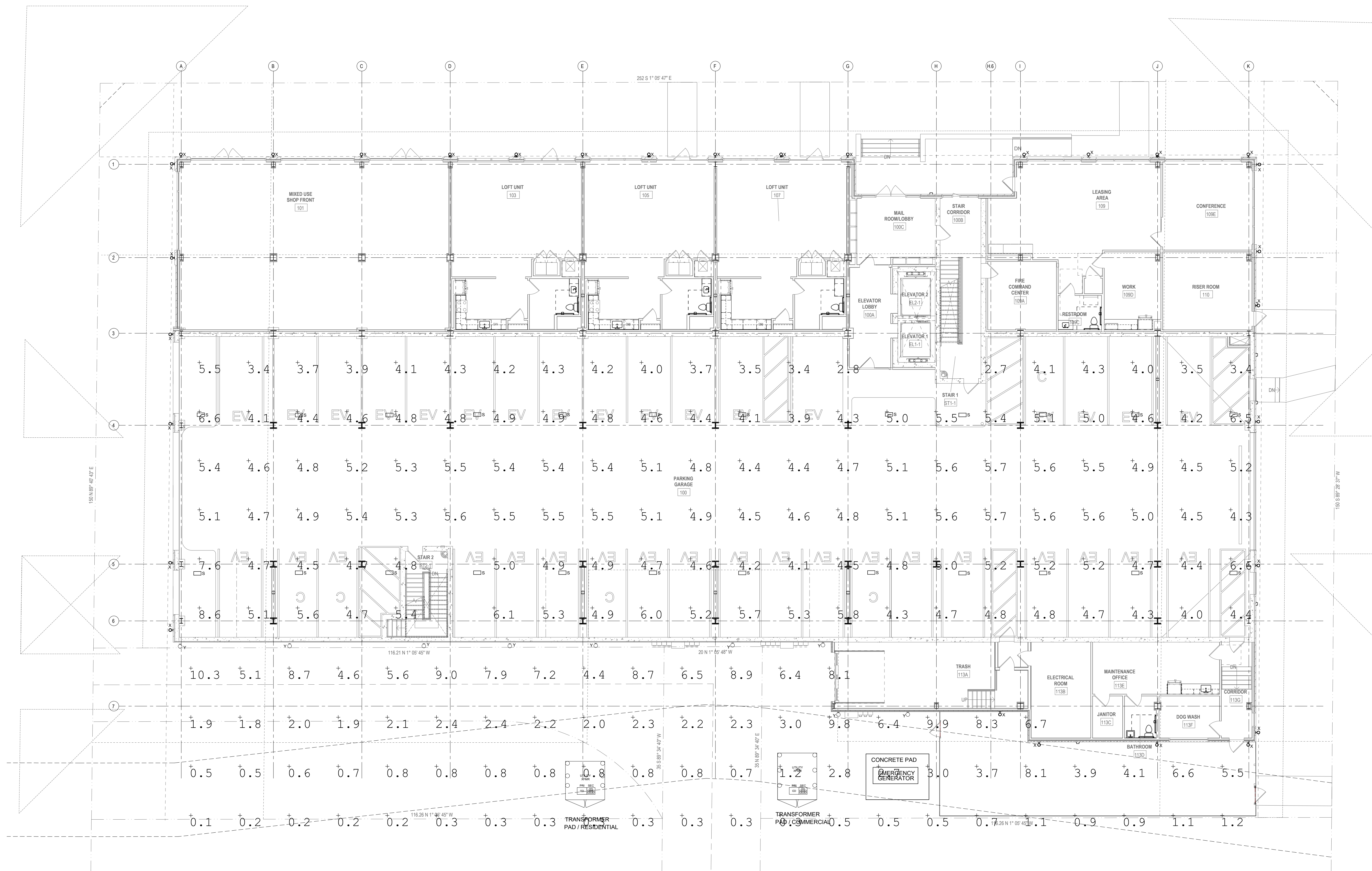

1 ELECTRICAL PHOTOMETRIC PLAN - FIRST FLOOR
1"=10'-0"

D-Series LED Parking Garage

Specifications

- Length: 12.5" (12.5")
- Width: 3.5" (3.5")
- Height: 2.2" (2.2")
- Weight: 1.8 lbs (1.8 lbs)

Introduction

The D-Series LED Parking Garage luminaire provides energy savings of 90% when replacing T8W metal halide luminaires. With an expected service life of over 100,000 hours (10-year life of 24/7 operation), up to 100,000 hours (10-year life of 24/7 operation) over the life of the product. All of the luminaire is 100% recyclable and is very low total cost of ownership. The luminaire features a wide beam angle and a D-Series Parking Garage luminaire to meet the demand of the industry, vertical and ambient. Exceptional glare control is achieved only by delivering the required vertical beam.

Operating Information

Item	Value	Item	Value	Item	Value
Beam Angle	120°	Color Temp	5000K	Input Voltage	120V
Beam Spread	120°	Color Temp	5000K	Input Voltage	120V
Beam Spread	120°	Color Temp	5000K	Input Voltage	120V

Notes:

- See notes on sheet 1 for mounting and wiring details.
- See notes on sheet 2 for mounting and wiring details.
- See notes on sheet 3 for mounting and wiring details.
- See notes on sheet 4 for mounting and wiring details.
- See notes on sheet 5 for mounting and wiring details.
- See notes on sheet 6 for mounting and wiring details.
- See notes on sheet 7 for mounting and wiring details.
- See notes on sheet 8 for mounting and wiring details.
- See notes on sheet 9 for mounting and wiring details.
- See notes on sheet 10 for mounting and wiring details.

2 LIGHTING FIXTURE CUT SHEET
SCALE: NONE

CONSULTANT:
WAHEED CONSULTING
MECHANICAL-ELECTRICAL-PLUMBING SYSTEM DESIGNS
Registration No. F-6336
TEL: (972) 783 2010, FAX: (972) 443 4963
420 PARKSIDE ST. MURPHY, TX, 75094
E-mail: waheedmp@yahoo.com

ART HOUSE
313 NORTH BECKLEY AVE,
DALLAS, TEXAS

PROJECT:
SEAL:

REVISIONS: DATE:
REV 2: OWNER CHANGES 10/10/24

TITLE:
ELECTRICAL PHOTOMETRIC PLAN FIRST FLOOR
DATE: 04/30/2024 SCALE:
DRAWN: CHECKED:
PROJECT #
SHEET NO: **E1.03**