

**Legend**

Description	Quantity	Unit
9" Interior Metal Stud Wall	193.9807	ft
11" Concrete Wall	643.0038	ft
11" Interior Metal Stud Wall	322.4784	ft
11" Metal Stud Wall	341.8014	ft
11 1/4" Metal Stud Wall	65.8669	ft
12 3/4" Metal Stud Wall	65.1467	ft
13 3/4" Metal Stud Wall	65.0667	ft
15 3/4" Metal Stud Wall	65.0667	ft
Interior Doors	33	Count

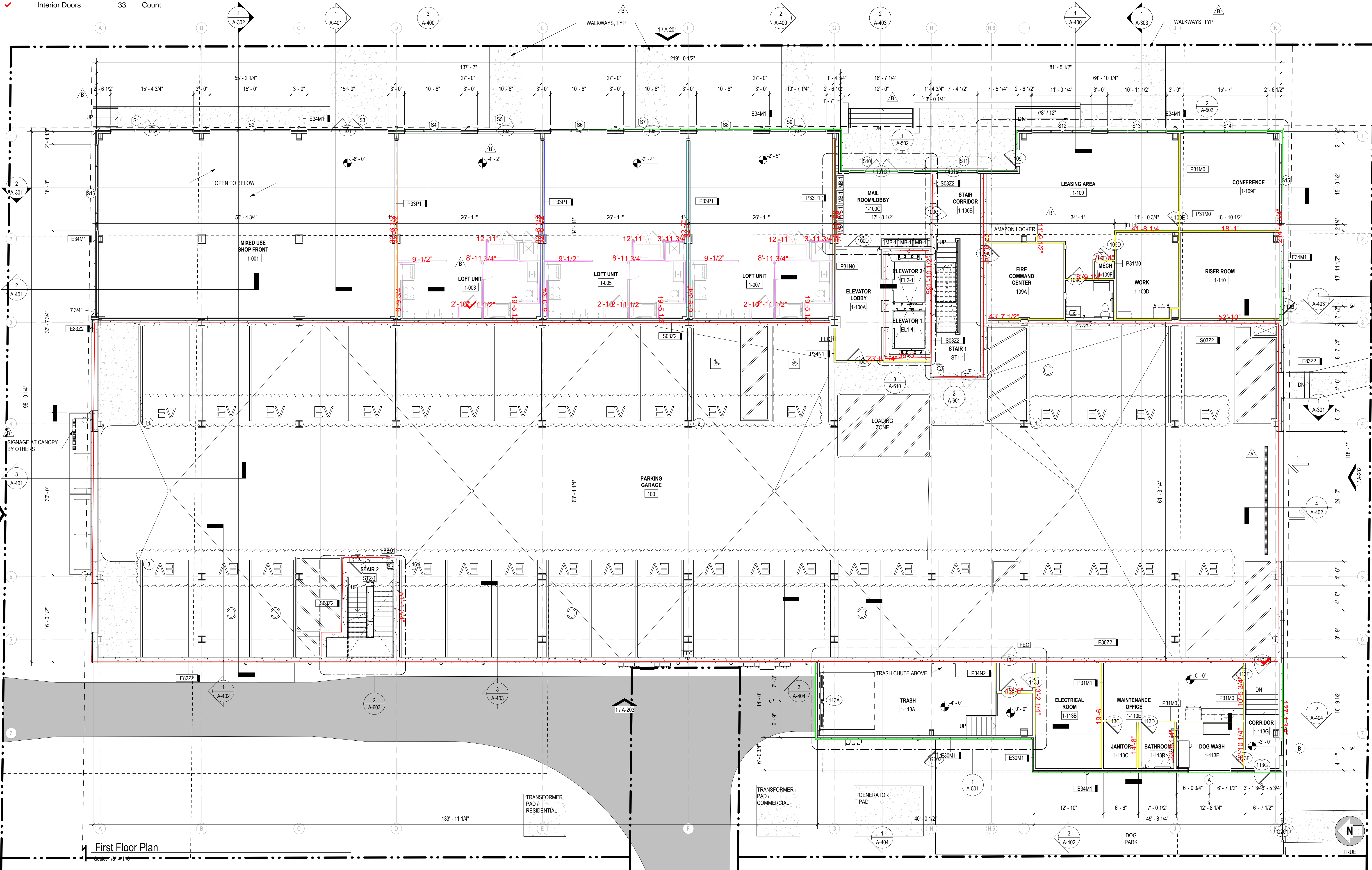

**BUILDING PLAN GENERAL NOTES**

- ALL DIMENSIONS ARE TO FACE OF STUD U.O.N. REFERENCE WALL SECTIONS, PLAN DETAILS & SECTION DETAILS FOR MORE INFORMATION.
- REFER TO SHEET G-201, G-202, and G-203 FOR ACCESSIBILITY DESIGN STANDARDS.
- ALL ANGLES ARE 45 TO THE HORIZONTAL & VERTICAL U.O.N.
- BLOWN INSULATION OCCURS IN ALL FLOOR/CEILING CONCEALED ASSEMBLIES IN ACCORDANCE WITH NFPA 13.
- ALL ACCESSIBLE DOORWAYS SHALL HAVE 2% MAX. SLOPE FOR A DISTANCE OF 80 INCHES PERPENDICULAR TO THE DOOR. THE THRESHOLD SHALL NOT EXCEED 1/2 INCH. ALL SPOT ELEVATIONS INDICATE TOP OF DECK U.O.N. IF SPOT ELEVATION FALLS ON CONCRETE SLAB, IT INDICATES TOP OF CONCRETE.
- INTERIOR CORRIDOR WALLS SHALL HAVE FULL HEIGHT CONTROL JOINTS EVERY 30 FEET MAX. AT DOOR JAMBS, RAMP, AND CONSTRUCTION JOINTS.
- KEYPAD AND/OR CARD READER ACCESS CONTROLS SHALL BE ACCESSIBLE LOCATIONS AND MOUNTED WITHIN 48" MAX. A.F.F.
- WALLS AND PARTITIONS WITHIN 2 FEET OF SERVICE SINK, URINALS, AND WATER CLOSETS SHALL HAVE A SMOOTH, HARD, NONABSORBENT SURFACE TO THE HEIGHT OF 48 INCHES MIN. A.F.F.
- REFER TO SHEET A-730 FOR WALL SCHEDULE AND ASSEMBLIES.
- INTERIOR DOORS SHOWN IN THE CORNER OF A SPACE ARE ASSUMED TO BE 4 INCHES FROM THE CORNER WALL STUD AND NEED NOT BE DIMENSIONED U.O.N.
- FURF-DOWNS MAY BE CONSTRUCTED USING ANY MATERIALS PERMITTED BY THE CONSTRUCTION TYPE AS DEFINED BY IBC. HOWEVER MATERIALS EXPOSED TO AIR FLOW (EXAMPLE: RETURN AIR PLENUM) MUST BE NON-COMBUSTIBLE OR MEET THE 25/80 FLAME SPOKE/SMOKE-DEVELOPED INDICES AS PER IMC 2021 SECTION 602.2.
- MEP CONTRACTORS SHALL SUBMIT SHOP DRAWINGS INDICATING COORDINATED MEP UTILITIES WITH CEILING/FLOOR DOWN HEIGHTS & WIDTHS TO BE APPROVED BY THE ARCHITECT.
- THE OWNER'S SIGN CONTRACTOR SHALL INSTALL BUILDING SIGNAGE PER CITY REGULATIONS, T.A.S. AND ANSI A117.1. REFER TO G-203.
- INSTALL FIRE EXTINGUISHERS PER CITY REQUIREMENTS WITHIN 75 FT TRAVEL DISTANCE SPACING. MOUNT EXTINGUISHERS ON HOOKS IN SERVICE AND GARAGE AREAS AND MOUNT EXTINGUISHERS IN SEMI-FLUSH RECESSED CABINETS IN ALL OTHER AREAS. REFER TO PLANS FOR ARCHITECT'S DESIRED LOCATIONS.
- ALL MECHANICAL, ELECTRICAL, AND PLUMBING WORK INCLUDING BUT NOT LIMITED TO DUCTWORK, PIPING, FANS, EQUIPMENT, SWITCHES, AND SENSORS SHALL BE INSTALLED SO AS TO NOT ENCRUSH INTO TO REQUIRED DIMENSIONS OF PARKING SPACES INCLUDING HEIGHT, WIDTH, STALL, AND DRIVE AISLE. A MINIMUM HEIGHT CLEARANCE OF 96 INCHES FOR HANDICAP VAN SPACES AND 84 INCHES FOR ALL OTHER SPACES MUST BE MAINTAINED AT ALL TIMES INCLUDING THE DRIVE AISLES USED TO NAVIGATE TO THOSE SPACES.

**BUILDING PLAN LEGEND**

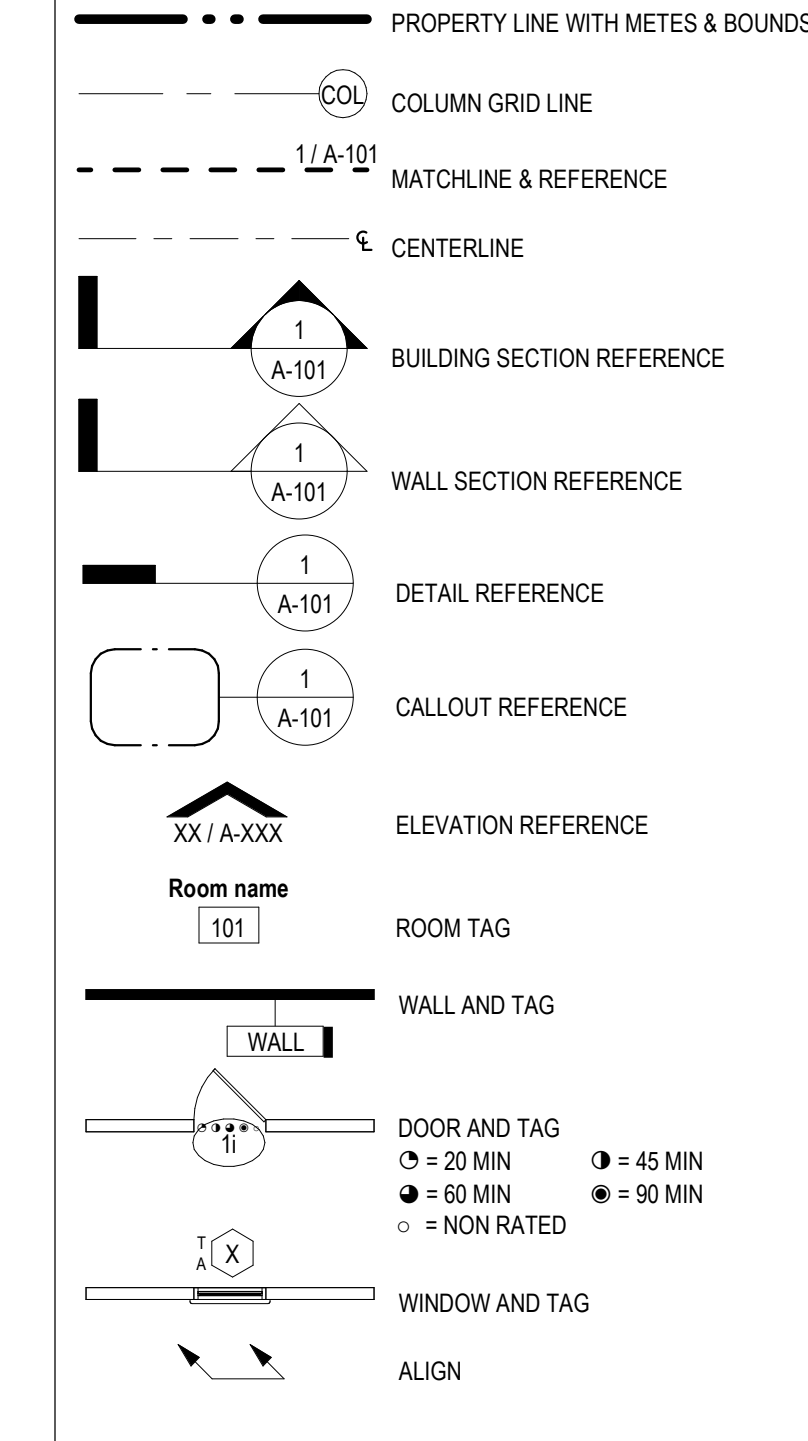

**WALL NOTATION LEGEND**

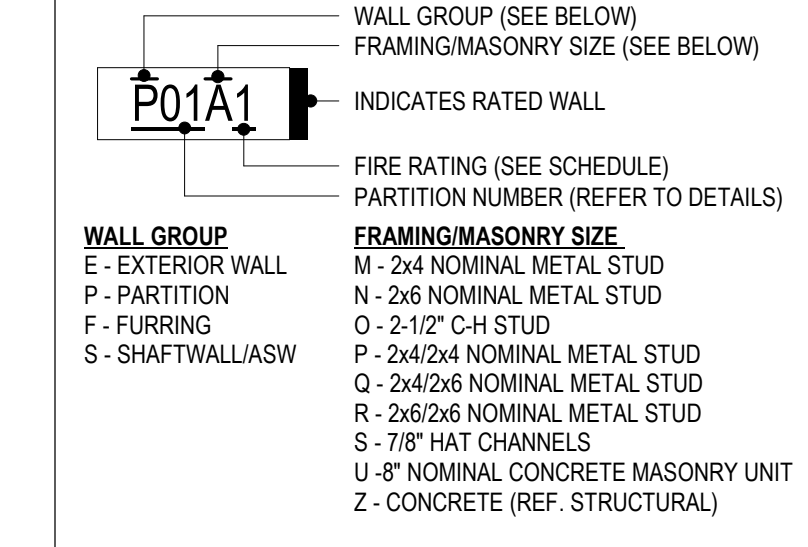

**GRAPHIC SCALE**

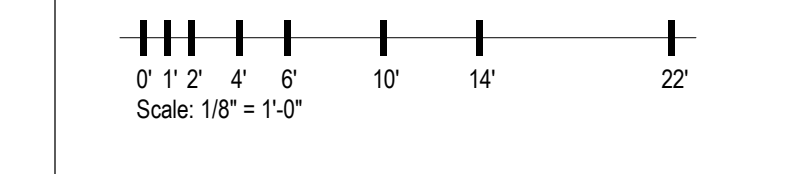

Client/Project  
 PROJECT NUMBER: 201408  
**ART HOUSE**  
 GSS, LLC  
 313 NORTH BECKLEY AVE  
 Q TEAM RESPONSE - [2024.05.03]

Revision	Description	Date
C	PROGRESS SET	TBD
B	Q TEAM RESPONSE	2024.05.03
A	Q TEAM RESPONSE	2024.03.08

Issue	Date
Q TEAM RESPONSE	2024.05.03
ISSUE FOR PERMIT	2023.12.22

IB, JDN  
 Drawn By ED  
 Reviewed By

Permit-Scale  
**PRELIMINARY NOT FOR CONSTRUCTION**  
 Not for permits, pricing or other official purposes.  
 This document has not been completed or checked and is for general information or comment only.  
 2024.05.03

Title  
**FIRST FLOOR PLAN**

Scale As indicated  
 Revision C  
 Drawing No.

**A-102**